



MR MODULO

ADJUSTABLE CONSTANT AIRFLOW REGULATOR

AIRFLOW & ZONE CONTROL **IOM**

READ AND SAVE THESE INSTRUCTIONS

SETTING THE AIRFLOW

Twist the rotating adjustment ring until the desired airflow is reached. Reference the correlation table at right and printed on the device. No tools required.

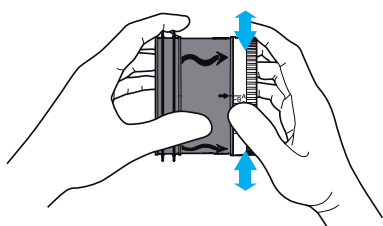

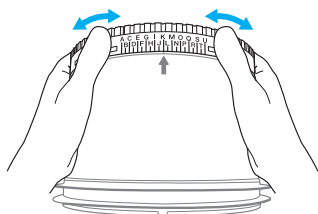

SMALL DIAMETERS





LARGE DIAMETERS

CORRELATION TABLE



11016307
Ø 3" (80 mm)

				
	m³/h	CFM	m³/h	CFM
K	20	12	-	-
J	25	15	-	-
H	30	18	-	-
G	35	21	45	26
F	40	24	50	29
B	45	26	60	35

P/N: 11016308
Ø 4" (100 mm)

				
	m³/h	CFM	m³/h	CFM
L	15	9	-	-
J	20	12	-	-
H	25	15	-	-
F	30	18	-	-
E	35	21	70	41
D	40	24	75	44
C	45	26	80	47
A	55	32	90	53

P/N: 11016309
Ø 5" (125 mm)
10-50 CFM (15-85 m³/h)

				
	m³/h	CFM	m³/h	CFM
L	15	9	-	-
I	25	15	-	-
G	-	-	60	35
F	30	18	65	38
D	-	-	70	41
C	-	-	75	44
B	45	26	80	47
A	50	29	85	50

P/N: 11016310
Ø 5" (125 mm)
60-110 CFM
(100-190 m³/h)

	m³/h	CFM
K	100	59
J	110	65
I	120	71
H	130	76
G	140	82
E	150	88
C	160	94
A	190	112

Certain letters correspond to two setpoints: one with the clip, and one without the clip.

P/N: 11016311
Ø 6" (150 mm)

	m³/h	CFM
R	100	60
P	110	65
O	120	70
M	130	75
L	140	80
K	150	90
J	160	95

P/N: 11016313
Ø 8" (200 mm)

	m³/h	CFM
U	225	132
S	250	147
Q	275	160
N	300	177
M	325	191
J	350	206
D	400	235

P/N: 110163114
Ø 10" (250 mm)

	m³/h	CFM
U	300	175
R	355	205
O	400	235
L	450	265
I	500	295
G	550	325
A	650	385

INSTALLATION

- The MR Modulo will push-fit into circular ducts in close proximity to a take-off or terminal
- Orient the MR Modulo according to the airflow direction indicated on the device.
- Horizontal or vertical mounting is acceptable.
- To avoid acoustic and aerodynamic disturbance, provide the following distance between the device and the terminal (grille / diffuser / inlet):
 - Exhaust Air: 1x the device diameter Ø
 - Supply Air: 3x the device diameter Ø

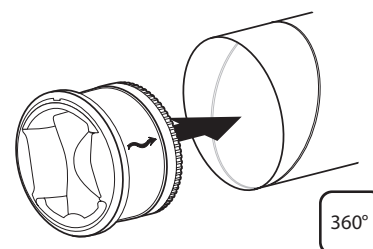

360°

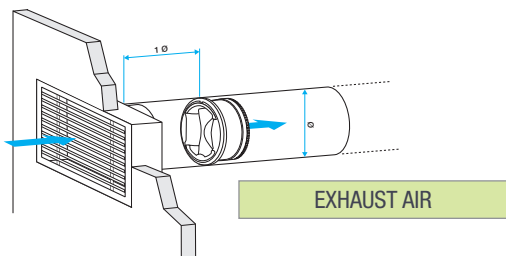

EXHAUST AIR

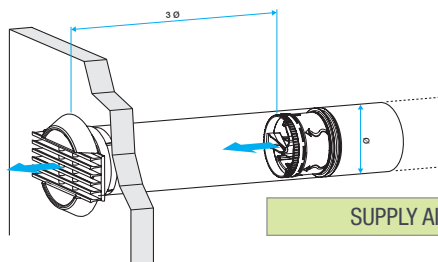

SUPPLY AIR

MAINTENANCE

- To maintain the MR Modulo's performance, it is advised to clean it regularly, especially if it is used in a dusty or greasy atmosphere.
- To facilitate regular inspections and cleanliness, place the MR Modulo in a fitting that has an easily accesible inspection window.
- Clean with soapy water. When cleaning, plug the hole on the plastic body at the base of the bulb in order to avoid blocking this orifice and to prevent any liquid or foreign body from passing inside the bulb.

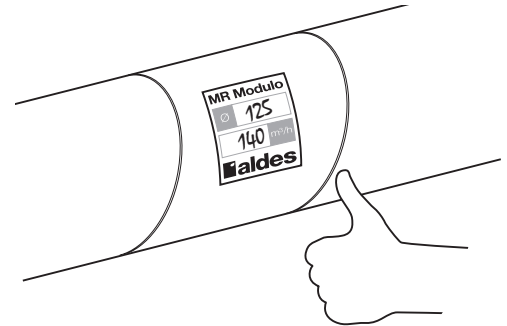

Write the diameter and airflow setting on the provided sticker and place it directly onto the duct to show where the MR Modulo has been installed.

TYPICAL APPLICATIONS

DUCT SYSTEM

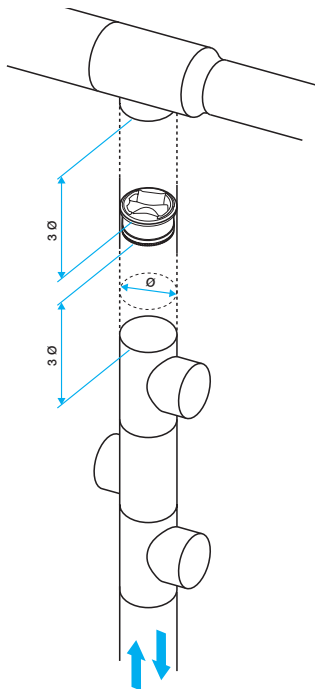

EXHAUST/RETURN AIR

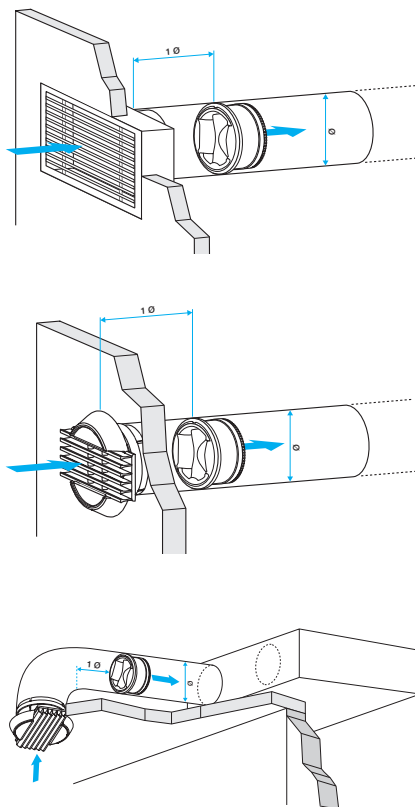

SUPPLY AIR

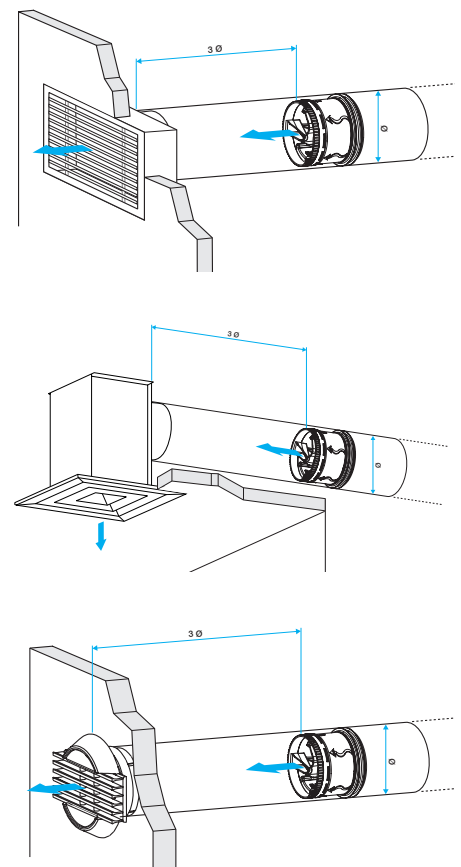

For more information, contact your Aldes sales advisor, visit aldes-na.com, call 1.800.255.7749, or find us on

