



InspirAIR® PRONTO

PRONTO 30

Energy Recovery Ventilator

PRODUCT
SPECIFICATIONS
SHEET



NOMINAL CAPACITY
800-3200 CFM

PLATE EXCHANGER
High Latent Transfer (sensible and latent heat transfer)

CASING
(Standard)

- Double-wall cabinet
- 22-gauge galvanized steel interior
- Access doors with quarter-turn handles
- 22-gauge galvanized steel drain pan
- Drain Connections: 1" (25 mm) NPT
- Insulation: 1" (25 mm)
- Painted white baked enamel outside finish
- Supply and exhaust hoods with bird screens
- Aluminium insulated motorized damper with endswitch contacts on outside air and exhaust air opening

MOUNTING (Standard)

- Standard Platform
- Isolated 18-gauge galvanized steel roof curb
Height: 14 inches (to order separately)

Product code: RC-Pronto30-I

ELECTRICAL & CONTROLS (Standard)

- Non-fused disconnect (NEMA 4)
- 24 V transformer for controls
- Single point power

Electrical Parameters			
KW	FLA	MCA	MOP
4.88	15	18.75	20

(Optional: Sold Separately)

- Bacnet MSTP controller kit **Product code: 699626**
- Bacnet IP Controller kit **Product code: 699627**

WARRANTY
Limited to 2 years on the cores and all covered components.

FILTERS
(Standard)
Quantity: 3 supply, 3 exhaust
Type: MERV 8
Dimensions: 16" x 20" x 3" (407 mm x 508 mm x 305 mm)
Dirty filter alarm

(Optional: Sold Separately)
MERV 13 Filters (substitute on supply air circuit only)
Product code: 607071

BLOWERS & MOTORS

- Quantity: 2 (1 per air stream)
- Plenum Type: Backward Inclined
- Permanently sealed and lubricated ball bearings
- Direct Drive EC Motor
- Available Voltages:
208 / 3 / 60Hz

FROST PREVENTION/CONTROL

- Fan defrost cycles activated by a temperature reference:
14°F (-10°C).

T2 < outside temperature < T1	Defrost time (mins)	7
	Exchange time (mins)	39
T3 < outside temperature < T2	Defrost time (mins)	7
	Exchange time (mins)	29.5
Outside temperature < T3	Defrost time (mins)	7
	Exchange time (mins)	20

T1 (°C)	-10
T2 (°C)	-18
T3 (°C)	-25

PRONTO 30: Ventilation Performance

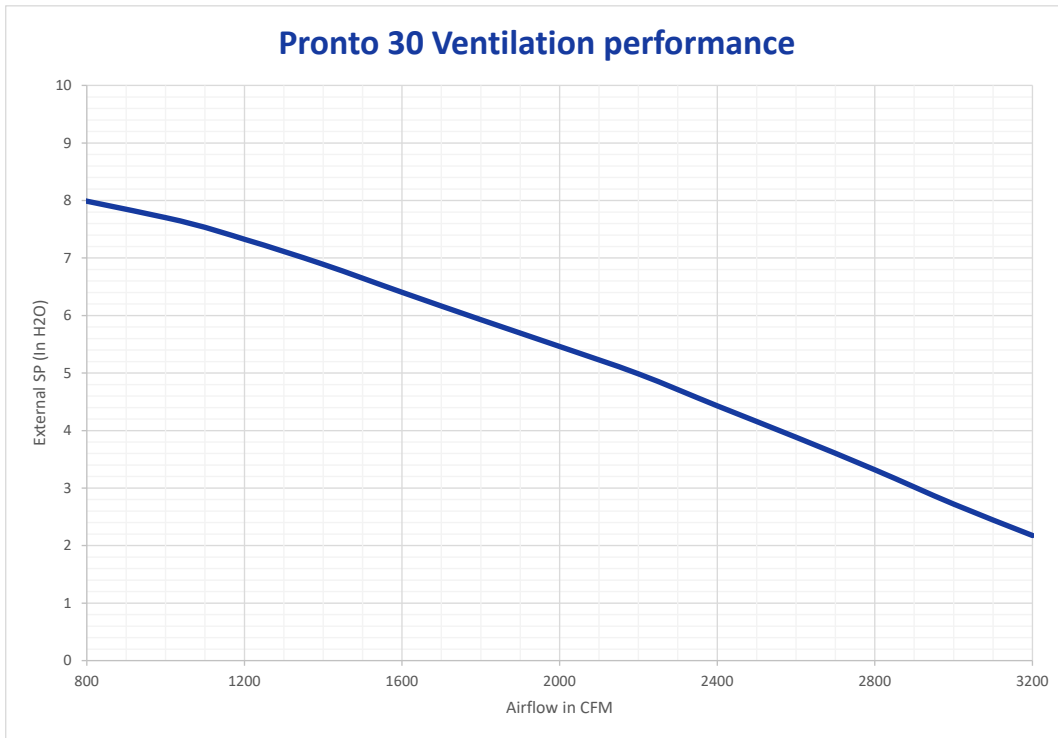

High Latent Transfer Core Performance

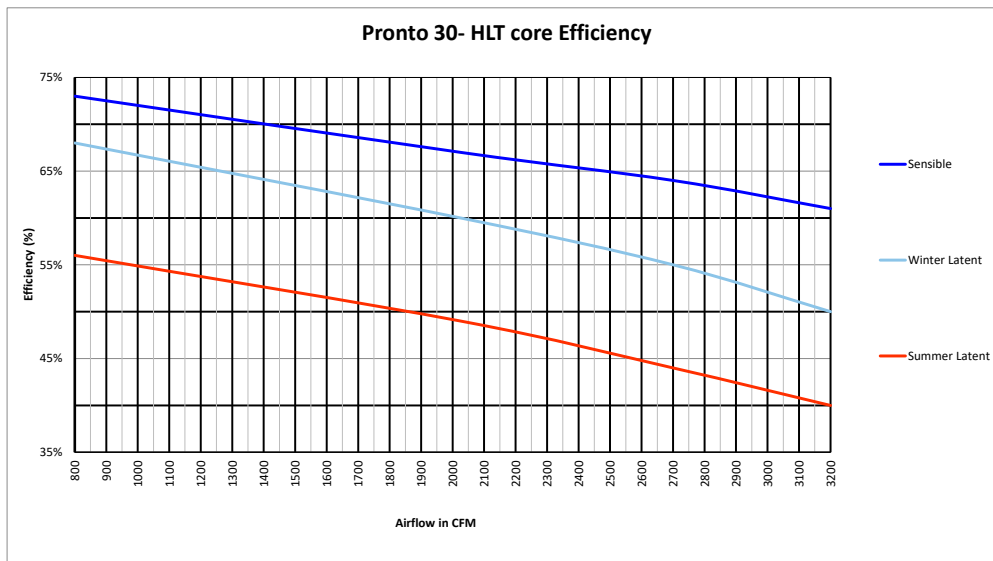

AHRI STANDARD CONDITIONS	CONDITIONS	
Outside Air Temperature	Winter	Summer
Dry Bulb	35°F (1.7°C)	95°F (35°C)
Wet Bulb	33°F (0.6°C)	78°F (25.6°C)
Exhaust Air Temperature	Winter	Summer
Dry Bulb	70°F (21.1°C)	75°F (23.9°C)
Wet Bulb	58°F (14.4°C)	63°F (17.2°C)

Note: Efficiencies are based on AHRI standard conditions.

PRONTO 30: Dimensions (Standard - inches)

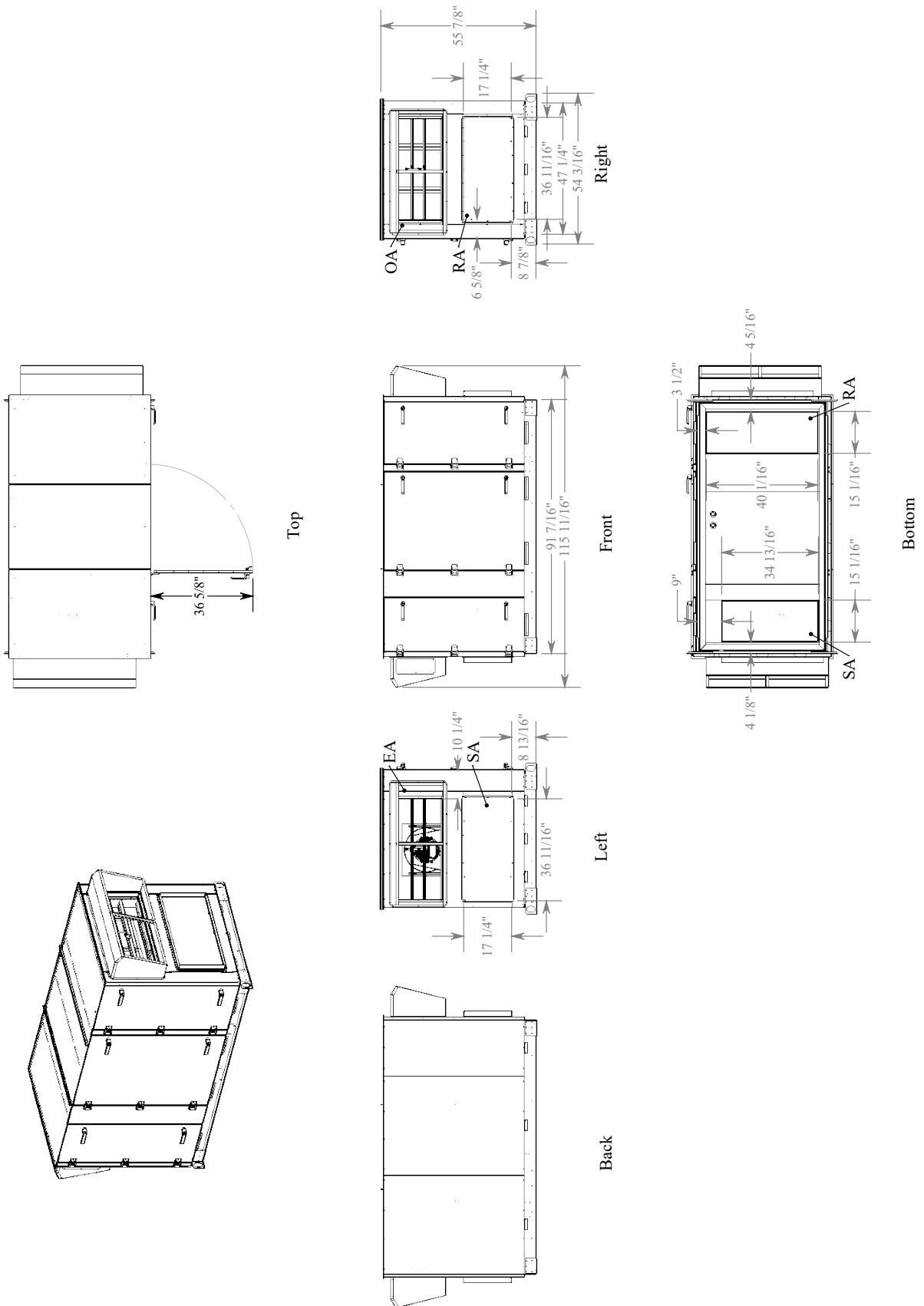

PRONTO 30: Roof Curb Dimensions - inches

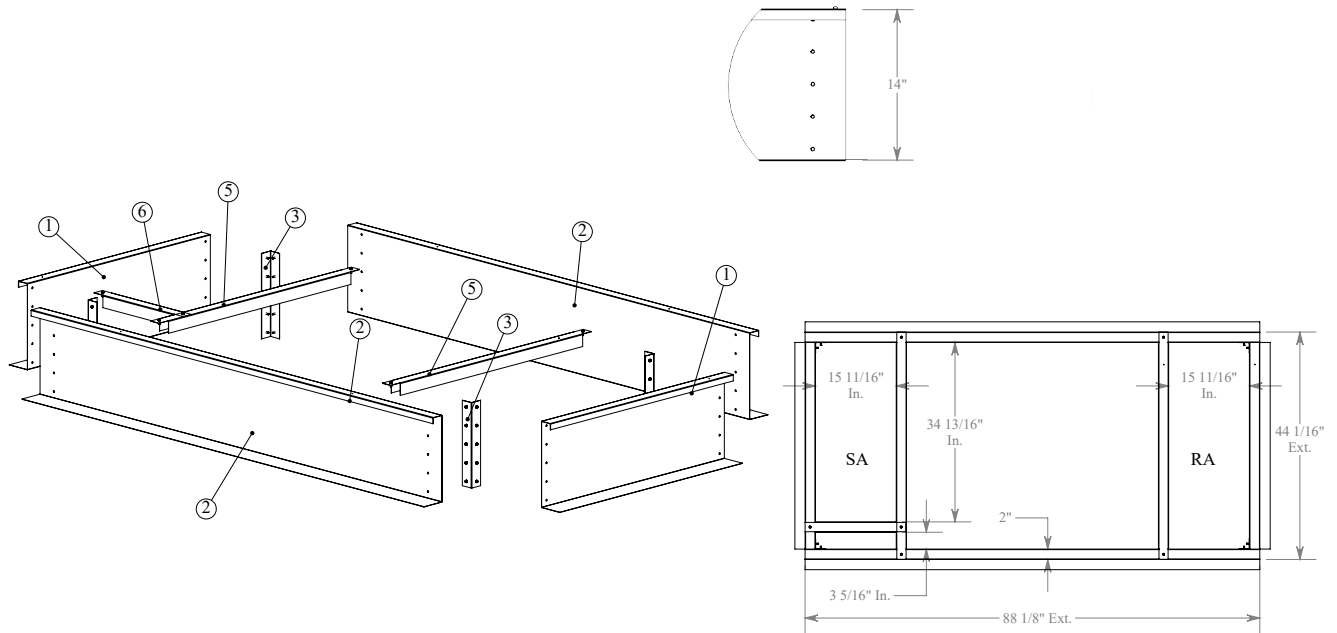

PRONTO 30: Configurations & Weights

AVAILABLE CONFIGURATIONS
1-2-5-6
1-3-4-6

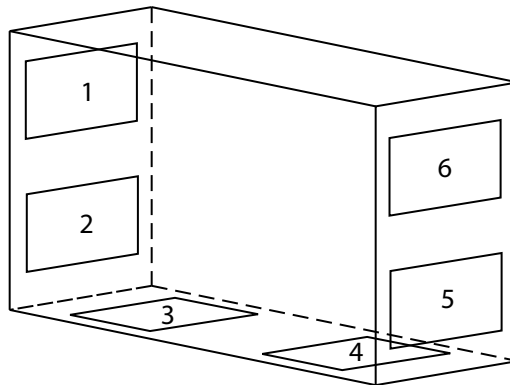

DUCT CONNECTION KEY	
1	Exhaust Air (EA)
2, 3	Supply Air (SA)
4, 5	Return Air (RA)
6	Outside Air (OA)

PRONTO 30 WEIGHTS	
Unit Weight	1600 lbs
Unit Shipping Weight	1700 lbs

For more information, contact your Aldes sales advisor, visit aldes-na.com, call 1.800.255.7749, or find us on

