

Fan Controls

Timers, controls, and switches

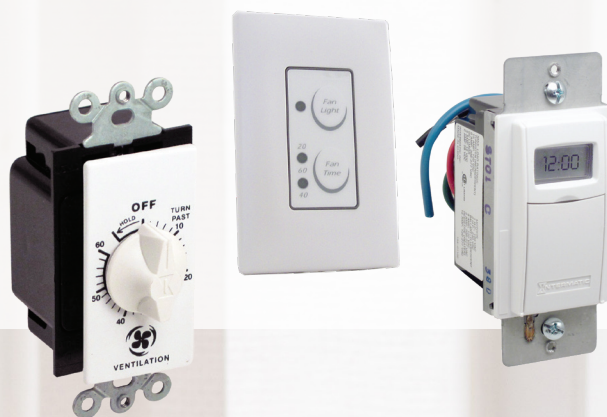

#HealthyLiving



American Aldes offers corresponding controls for ventilation products. The controls range from twist timers to advanced pressure-sensing controls for regulating ventilation in large buildings.



Electronic Push-Button Timer

- Assures sufficient run-time to remove odors and humidity from bathrooms and kitchens.
- Ideal for controlling a 120V load.
- LED display.
- Pre-set time delays of 15, 30, 60, or 120 minutes.
- Fits in single or multi-gang wall boxes.
- UL listed to US and Canadian standards.



Installation

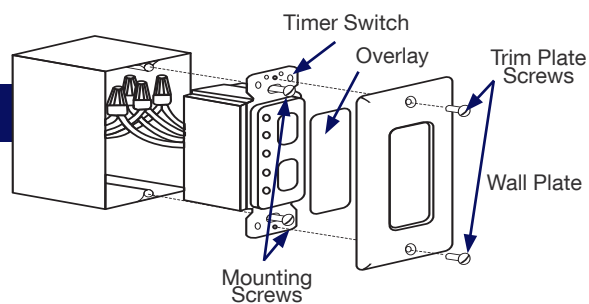

Electronic Fan/Light Timer

- Use for turning “ON” fan and light circuits simultaneously.
- Use for turning the light “OFF” manually, allowing the fan to remain on for a manually pre-set delay time of 20, 40, or 60 minutes.
- Selected delay time remains in memory until changed by the user.
- LED display.
- Fits in single or multi-gang wall boxes.
- Use for residential and commercial bathrooms.



Operation

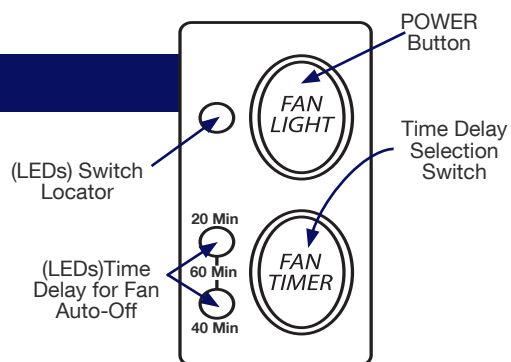

Fan/Light Timer Switch

- Activated to remove excess humidity.
- Controls the fan and light with one switch.
- Single or multi-gauge installation.
- Three position switch for ON/OFF and Timed Off.
- Adjustable 1 to 60 minute time delay setting.
- 120 VAC load.
- Wall-mount.

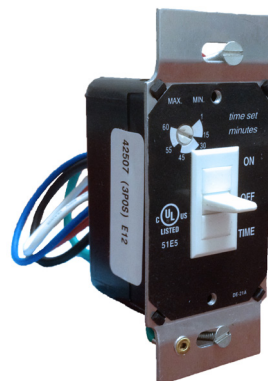

Installation

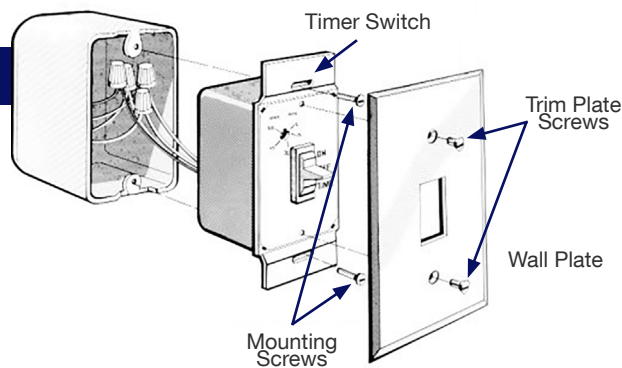

Spring-Wound Twist Timer

- One-hour timer switch.
- Dial plate available in white.
- Hold feature enables user to override the automatic shut-off function.
- Supplied time dial plates are designed to fit either toggle (FF) or decorator style (FD) switch plates.
- Single or multi-gang with no field modifications required.
- Time saving up front terminal connection with teeter-type terminals.
- Press-on knob design ensures quick and easy installation.
- CFL Compatible.



7-Day Programmable Timer

- Controls lighting, including fluorescent, and heavy-duty loads such as fans and appliances.
- LCD digital clock and read out.
- Easy-to-set 6-button programming with 6 ON/OFF settings per 7-day period (total of 42 ON and 42 OFF settings per week).
- 4 separate programming options: Same settings Monday through Friday, weekends, all 7 days of the week, or individual daily settings.
- Battery back-up prevents program loss due to power failure.
- Flush-mount design.



Installation

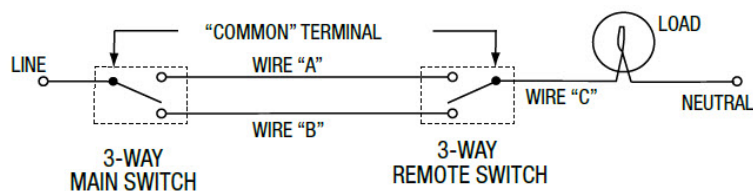

TYPICAL EXISTING
2-SWITCH SETUP

Variable Speed Controls

- Offered as accessories to the line of in-line, wall- and roof-mount fans for air-moving applications.
- Designed to replace obsolete tapped winding or reactive methods of speed control.
- Built-in On/Off AC line switch.
- Minimum Speed Trimpot.
- Mounts in a standard 2" x 4" electrical wall box.



P/N: 99 250 & 99 251

P/N: 99 022

Dimensions

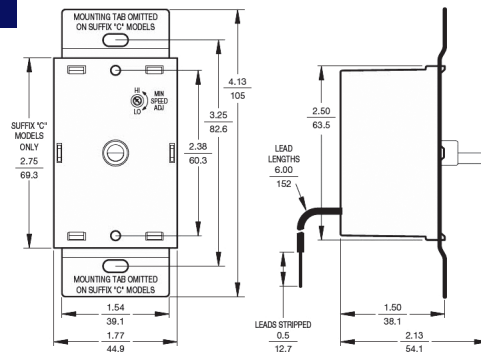

P/N: 99 022

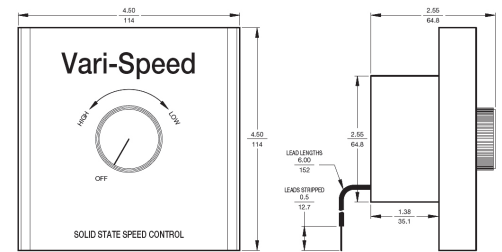

P/N: 99 250 & 99 251

Zone Terminal Control

- The Zone Terminal and Fan Control Center (ZTC) provides low-voltage control of the line-voltage circuits.
- Used to control blower motors and auxiliary circuits in ventilating equipment.
- ZTC can control up to (8) 24V American Aldes patented* Zone Register Terminals (ZRT®).
- Low-voltage terminal strips with standard terminal designation for easy wiring.
- Secure mounting method from inside the control box cover.

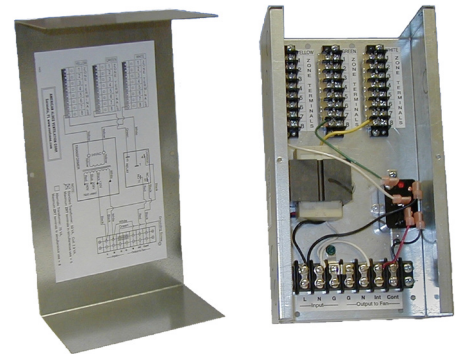

ZTC

Mounting

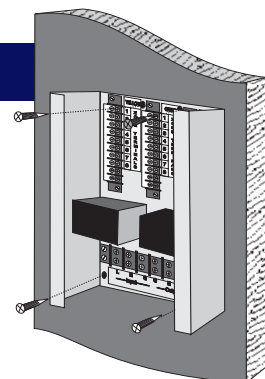

*U.S. Pat. No. 7,766,734

Zone Pressure Regulator

- Compact, TRIAC-based fan and motor control designed for HVAC, electronics, and industrial controls markets.
- Automatically controls most single-phase AC fans and motors used in exhaust ventilators, duct fans, and blowers.
- Features an automatic voltage and frequency detection.
- The 6" x 11" job-box mount makes the microprocessor-based design flexible and economical.
- Decreases acoustical noise, pressure or flow regulation, system reliability, increased fan life, improved safety, and energy savings.



Wiring

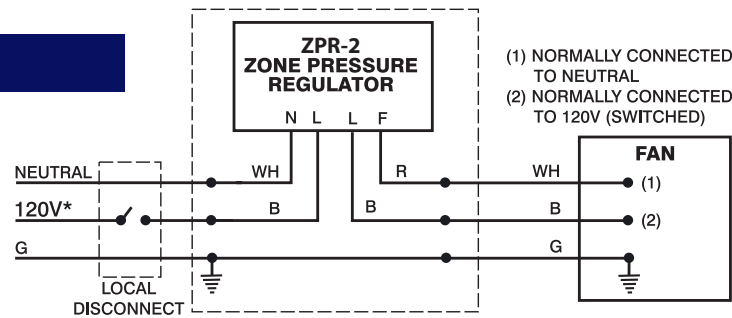

Positive/Negative Pressure Switch

- Positive/Negative Pressure Switch is adjustable to between 0.05" to 1.0" w.g. differential pressure by using positive or negative pressure taps.
- Suggested Use: Sensing range hood operation and initiating a make-up air fan.
- Electrical Ratings: Switch suitable for 115 V supply. 10 A rating.

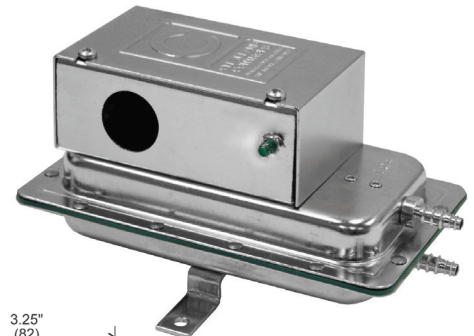

Dimensions

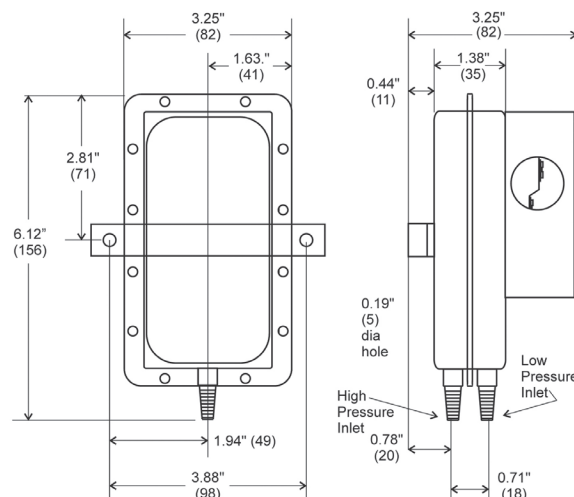

Pressure/Timer Switch

- Recognizes dryer operation and activates a booster fan from an independent electrical circuit.
- When the dryer begins operation, positive pressure in the duct causes the switch diaphragm to expand, closing the circuit to the booster fan.
- Features an integral delay-on-make timer in the switch which turns the fan on for intervals of 10 minutes.
- Drying cycles, the booster fan, the delay timer, and the pressure switch are not adversely affected by the starting/stopping intervals.
- 115 V supply.



Dimensions

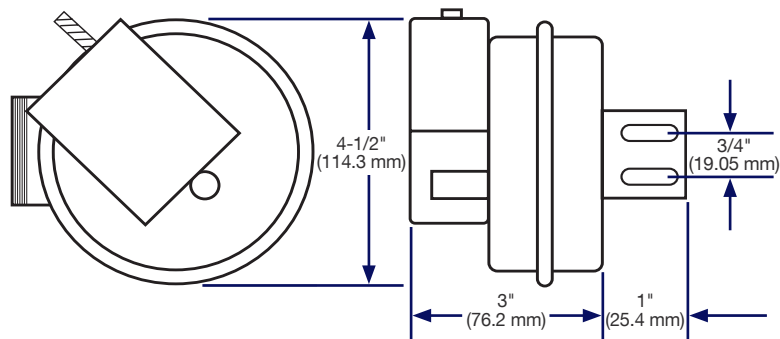

Current Sensing Switch

- Senses when a clothes-drying device is drawing between 1 and 50 Amps of current.
- Relay contact closes and turns on the fan when current reaches the threshold.
- When the current drops below the threshold, the relay contact opens back up and turns off the fan.
- The sensor is rated to control 115 V supply.
- Designed to mount in a standard electrical box.



Dimensions

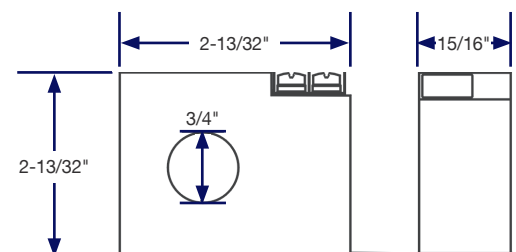
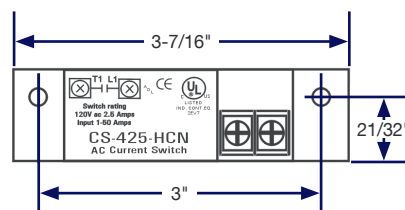

www.aldes.us

To find out more about Fan Controls and other related products
visit **www.aldes.us/fan-controls**

Distributed By:



American ALDES Ventilation Corporation
4521 19th Street Court East, Suite 104 - Bradenton, FL 34203 USA
Tel: 941.351.3441 - Fax: 941.351.3442 - Toll-Free: 1.800.255.7749

© 2019 American ALDES Ventilation Corporation. Reproduction or distribution, in whole or in part, of this document, in any form or by any means, without the express written consent of American ALDES Ventilation Corporation, is strictly prohibited. The information contained within this document is subject to change without prior written notice

