



AIRFLOW & ZONE CONTROLS  
**OSG**  
 Occupancy-Sensing Grilles

INSTALLATION  
 OPERATION  
 MAINTENANCE

**READ AND SAVE THESE INSTRUCTIONS**



**DESCRIPTION**

The OSG Occupancy-Sensing Grille is a stand-alone terminal that automatically boosts the exhaust airflow when a room is occupied. A lens detects movement and triggers circuit opening (instantaneous) and closing (after a 20-minute time out). During installation, the grille is manually set for a boost flow rate of 15,30,45, or 60 CFM. The minimum airflow rate is 3-5 CFM when the space is unoccupied.

**SWITCH**

A switch allows the user to set the basic airflow according to the standard occupancy level of the room.

OSG MODELS					
Part Number	Model	Timer	Power Supply	Connection to Relay	Type of Relay (Not Included)
17 105	OSG-9V	20-minute	Connector for standard 9V alkaline 6LR61 battery (battery supplied)	--	--
17 106	OSG-12V	20-minute	12 VAC (black cable)	--	--
17 126	OSG-12V+	20-minute	12 VAC (black cable)	Cable for relay (gray cable)	6V DC relay, coil current, 100mA max.
17 107	OSG-F	--	--	--	--

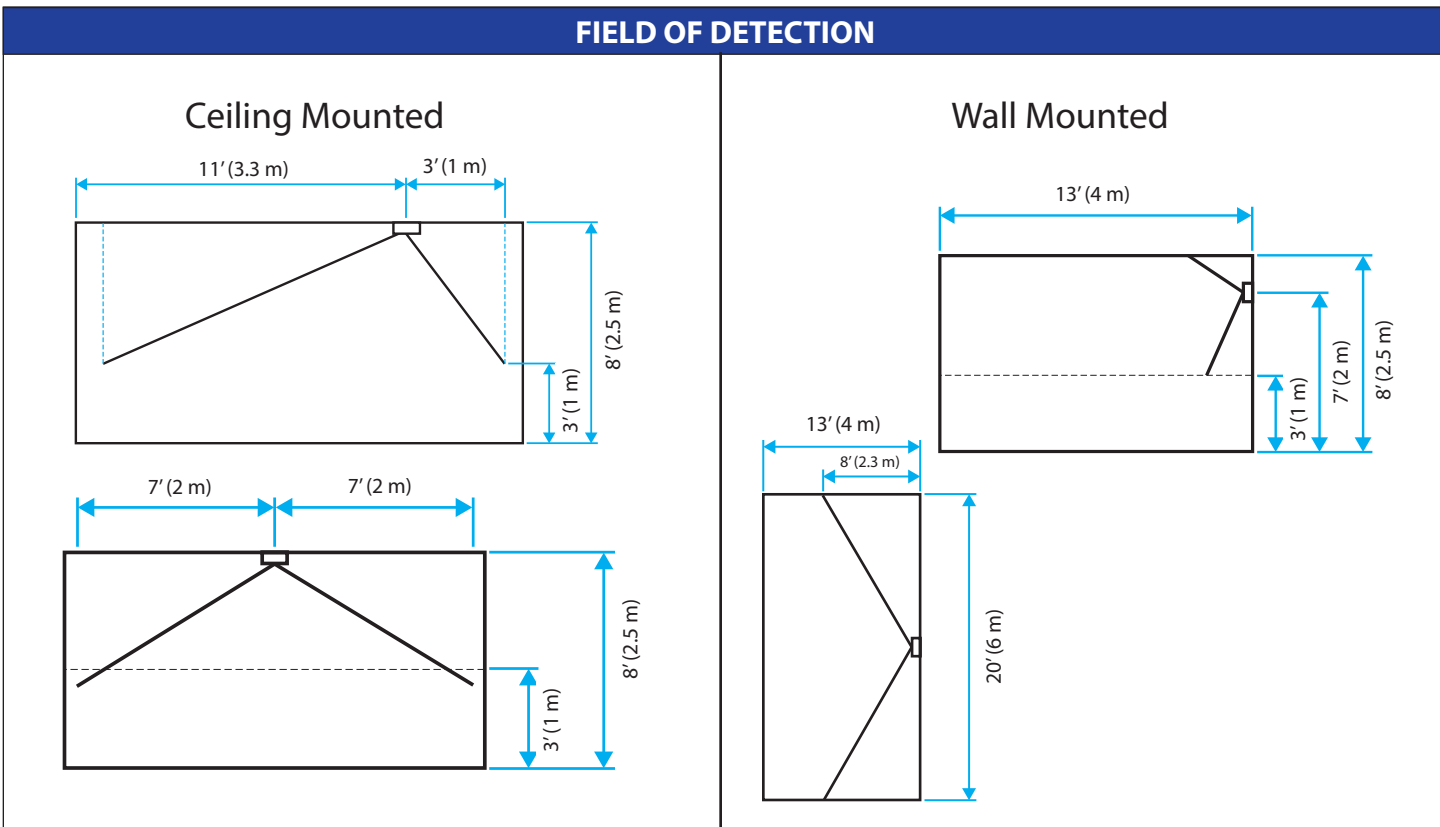

## OSG-9V Installation

<p>1.</p>	<p>2.</p> <p>9V DC battery</p>	<p>3.</p>
<p>4.</p>	<p>5.</p> <p>Ø 5"</p>	<p>9V DC</p> <p>Note: 9V DC alkaline battery installed at factory. Follow steps 1-4 to replace battery.</p>

## OSG-12V Installation

<p>12VAC</p>	<p>1.</p> <p>12VAC</p> <p>0.5A, 6W</p>	<p>2.</p> <p>Ø 5"</p>
--------------	--	-----------------------

# OSG-12V+ Installation

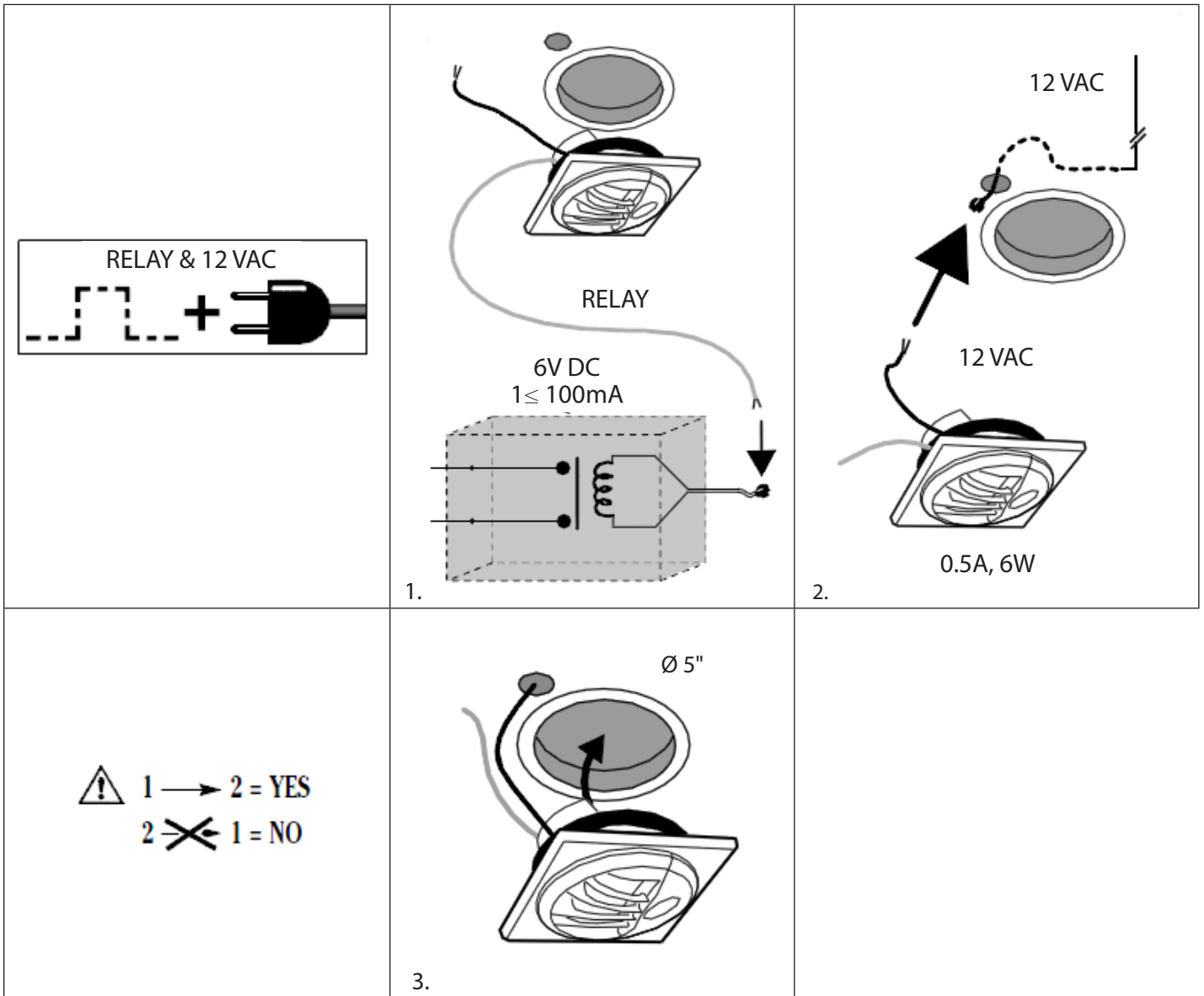

## Orienting the OSG

Position the OSG so that the occupancy sensor faces into the room.

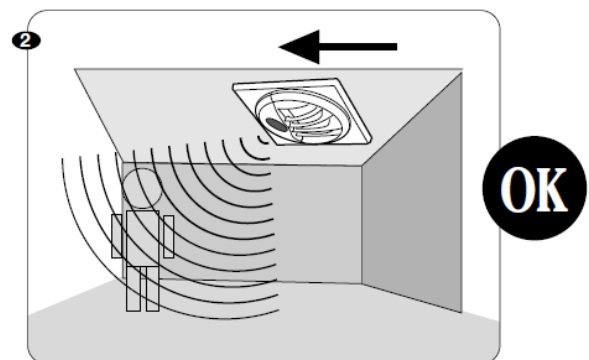
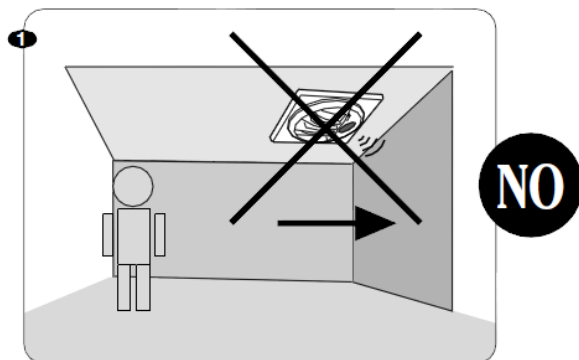

# Setting the Airflow

## VENTILATION PROPERTIES

- Basic flow rate manually adjustable by the switch: 15, 30, 45 or 60 CFM.
- Flow rate automatically reduced to 3-5 CFM when the room is unoccupied.
- Airflow rates are based on 0.40 in. w.g. (100 Pa).
- The OSG operating range is from 0.28-0.52 in. w.g. (70-130 Pa). Under these usage conditions, the relative variation of the flow at each ventilation orifice is limited to 15%.
- Manually adjustable maximum airflow setpoints based on the table at right.

Switch Position	Corresponding Flow Rate
•	15 CFM
• •	30 CFM
• • •	45 CFM
• • • •	60 CFM



Switch

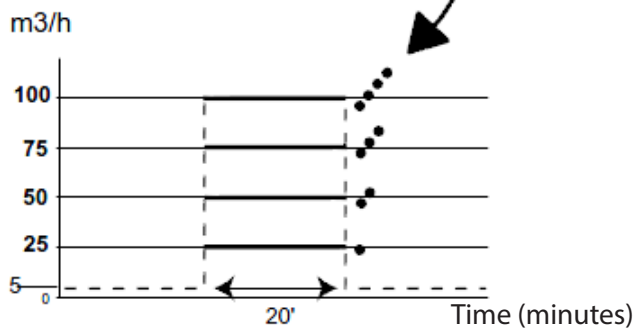
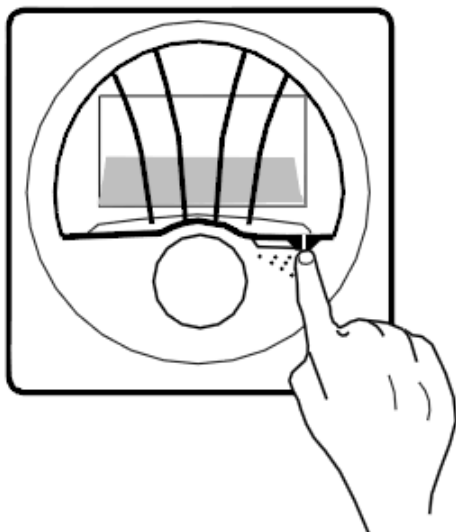

## Airflow Performance

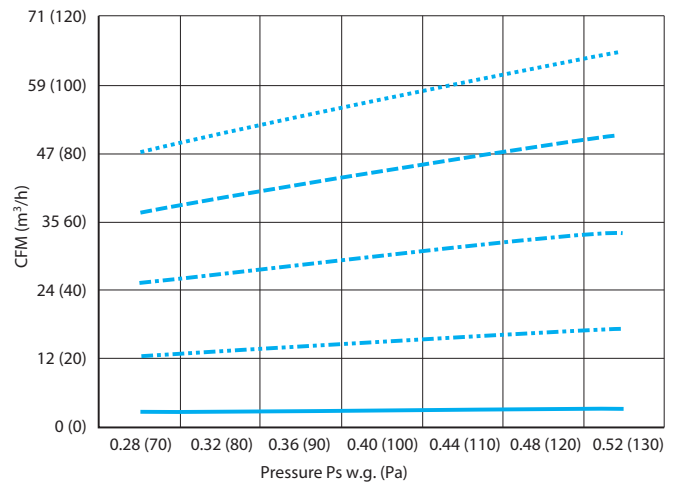
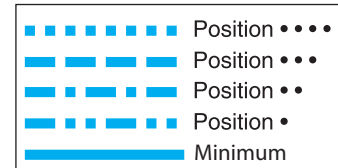

© 2014 American ALDES Ventilation Corporation. Reproduction or distribution, in whole or in part, of this document, in any form or by any means, without the express written consent of American ALDES Ventilation Corporation, is strictly prohibited. The information contained within this document is subject to change without prior written notice.