

**STANDARD HCG
HUMIDITY CONTROLLED GRILLE**

INSTALLATION
INSTRUCTIONS
0909

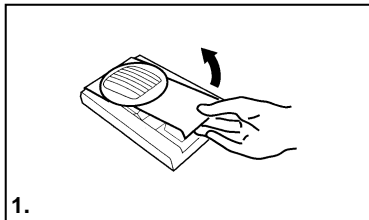

1.
Remove face grille from base.

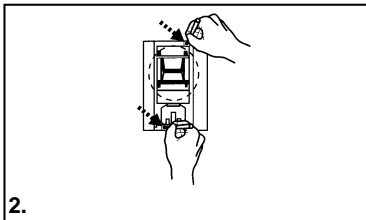

2.
Position grille base over duct and mark
holes for drilling.

*Note: use off-centered holes.
Centered holes are for attaching face grille.*

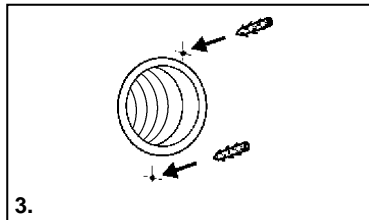

3.
Provide anchors if necessary. It is
suggested that grille be attached at both
points.

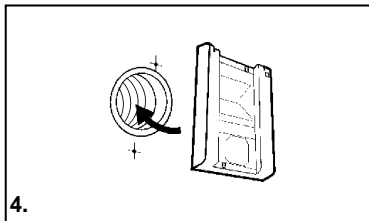

4.
Position grille base.

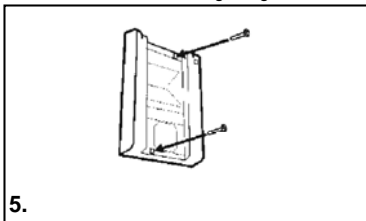

5.
Attach base with 2 appropriately sized
screws.

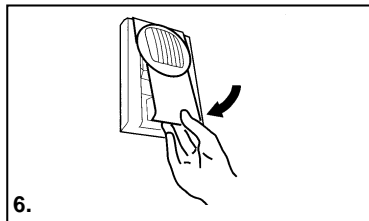

6.
Snap on face grille.

American ALDES Ventilation Corp.

4521 19th Street Court E., Suite 104, Bradenton, FL 34203, USA

P: 941-351 3441 - TF: 800-255-7749 - F: 941-351-3442 - www.americanaldes.com - e-mail: info@aldes-us.com